

Communication Module Installation Instructions

For LG Water Heaters

Follow this step-by-step guide to connect your LG water heater to WatterSaver.

Step One: Gather Required Equipment

- Communication module (UCM) – provided by WatterSaver
- Screwdrivers (Phillips and flathead)

Step Two: Turn Off Power to Your Water Heater

WARNING: Before continuing with the UCM connection, turn off power to your water heater at the circuit breaker or fuse box by flipping the breaker supplying power to your water heater to the OFF position or by removing the fuse. **WORKING ON AN ENERGIZED CIRCUIT CAN RESULT IN SEVERE INJURY OR DEATH FROM ELECTRICAL SHOCK. TURN POWER OFF BEFORE PERFORMING THIS INSTALLATION. CHECK THE WIRE WITH A NON-CONTACT CIRCUIT TESTER TO MAKE SURE POWER IS OFF.**

Step Three: Open the UCM Port

Locate the UCM port (typically on top of the water heater) and unscrew the port cover. This will expose the port.

Step Four: Prepare and Install the UCM

- Prepare the UCM as described in the provided Manual
- Insert the UCM into the port by aligning the UCM connectors with the connectors in the port
- Push in until the bottom face of the UCM touches the flat face of the receiver. Make sure it is securely seated.*
- Use screws to secure the UCM to the receiver

*LG water heaters are sensitive to partial insertion – make sure the UCM is fully pushed in.

Step Five:

Turn on the power to your water heater at the circuit breaker or fuse box by flipping the breaker supplying power to your water heater to the ON position or by replacing the fuse.

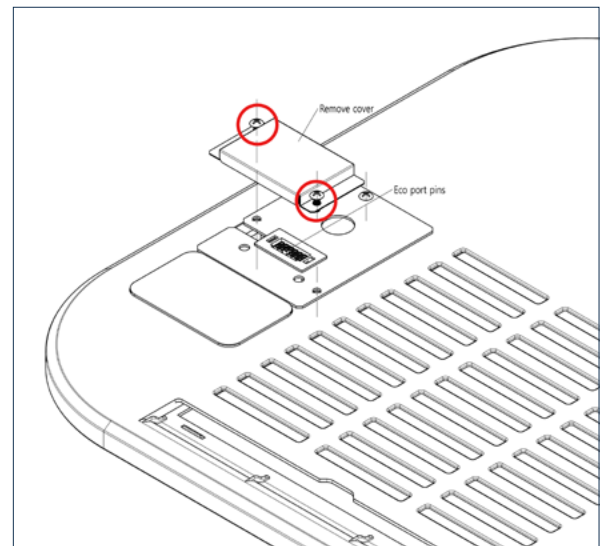

Step Six: Confirm Successful UCM Connection

- Once connected, the UCM LED will blink during startup
- Within a few minutes, the UCM LED should turn solid blue, indicating connection
- If you have trouble with the connection, refer to the troubleshooting steps in the UCM Installation Guide or contact our program for support at support@watter-saver.com

Step Seven: Set Up LG ThinQ App (if not already done)

1. Download the LG ThinQ app from your phone's app store.
2. Create an account or log in to your existing account.
3. On the water heater, press and hold the **Wi-Fi/Connectivity** button (or follow the unit control panel's instructions) until the Wi-Fi indicator begins blinking.
4. Open the ThinQ app and tap the "+" button in the top right corner.

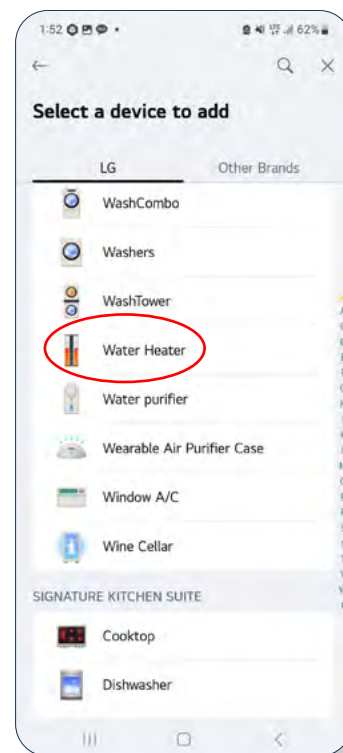
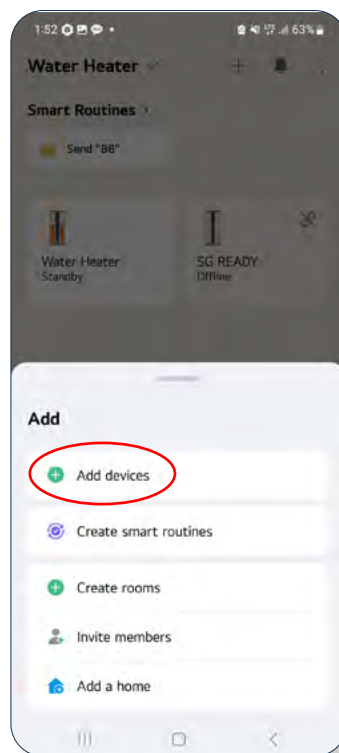
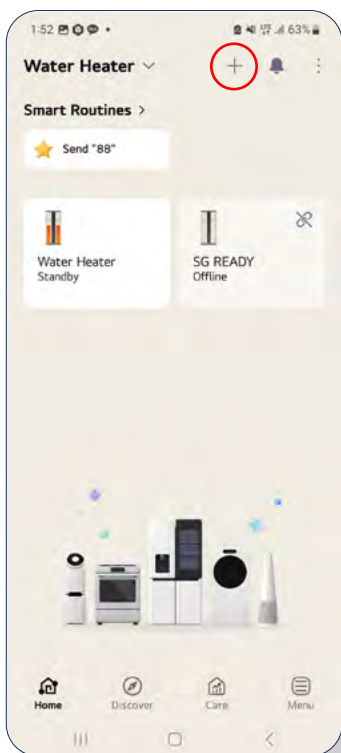
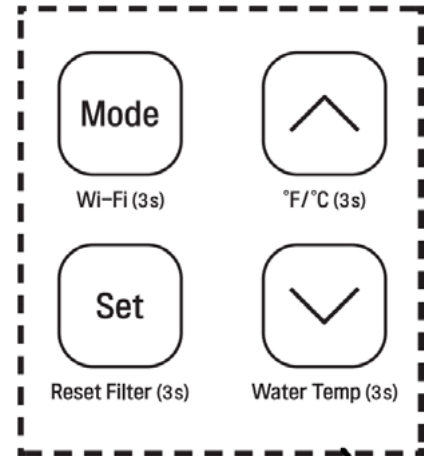

5. Select "Add Device," then choose "Water Heater"
6. Follow the on-screen instructions to complete setup.

Step Eight: (Optional): Enable Advanced Load Up (ALU)

Only follow this step if a thermostatic mixing valve is installed with your water heater.

7. Open the ThinQ app and select your water heater.
8. Navigate to **Demand Response / Grid Services settings**.
9. Locate the Advanced Load Up (ALU) option.
10. Toggle the setting to ON.

Note: This option may only appear if the UCM is properly installed and connected, and if the device is enrolled in a compatible program.

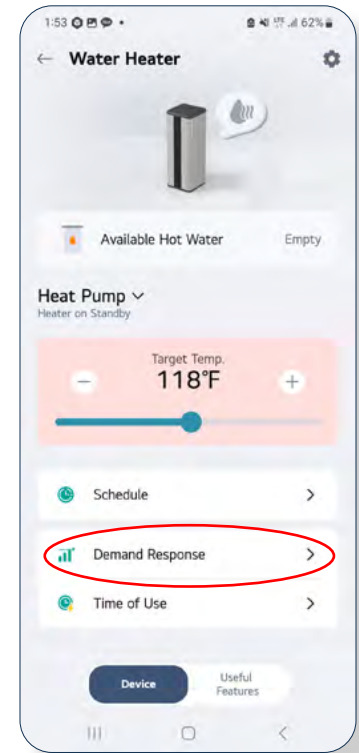
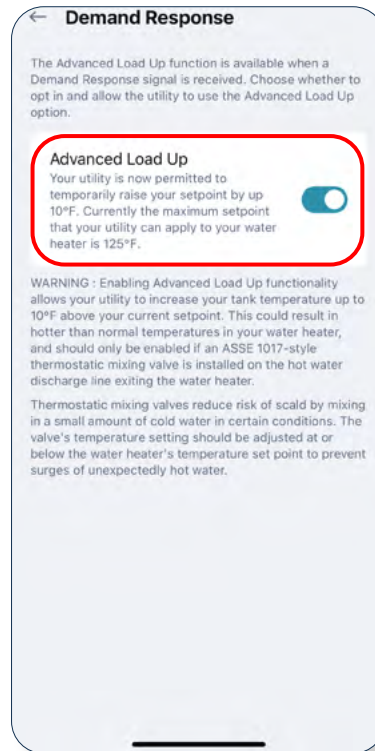

Step Nine: Connect Your Water Heater to WatterSaver

Once you've completed these steps, please email support@watter-saver.com to let the support team know that your UCM is installed and that you are ready to participate in WatterSaver.